

*Effective Date: February 2025**This listing is subject to re-examination in one year.*www.icc-es-pmg.org | (800) 423-6587 | (562) 699-0543*A Subsidiary of the International Code Council®*

CSI: DIVISION: 22 00 00—PLUMBING
Section: 22 40 00—Plumbing Fixtures (Shower Pan Liner)

DIVISION: 09 00 00— FINISHES
Section: 09 30 00—Tiling

Product certification system:

The ICC-ES product certification system includes testing samples taken from the market or supplier's stock, or a combination of both, to verify compliance with applicable codes and standards. The system also involves factory inspections, and assessment and surveillance of the supplier's quality system.

Product: KurbX Shower System

Listee: KurbX, LLC
3 E. Main St.
Black River Falls, WI 54615
www.kurbx.com

Compliance with the following codes:

2024, 2021, 2018, 2015, 2012 and 2009 *International Plumbing Code*® (IPC)
2024, 2021, 2018, 2015, 2012 and 2009 *International Residential Code*® (IRC)
2024, 2021, 2018, 2015, 2012 and 2009 *Uniform Plumbing Code*® (UPC)*
2022 and 2017 *Uniform Illustrated Plumbing Code-India*™ (UIPC-I)*
2020, 2015 and 2010 *National Plumbing Code of Canada*® (NPC)**

*Copyrighted publication of the International Association of Plumbing and Mechanical Officials

** Copyrighted publication of the National Research Council Canada

Compliance with the following standard:

TCNA/ANSI A118.10-2023, Load Bearing, Bonded, Waterproofing Membranes for Thin-Set Ceramic Tile and Dimension Stone Installation
ASME A112.18.2/CSA B125.2-2020, Plumbing Waste Fittings
IAPMO PS 106-2015e1, Tileable Shower Receptors and Shower Kits

Identification:

Packaging label for each system shall include the manufacturer's name or trademark as well as the ICC-ES PMG certification mark.

Installation:

The Shower Systems shall be installed in accordance with the manufacturer's published instructions and the applicable code(s). Shower system components shall be assembled and can be customized in the field. All shower bases and panels can be cut to size using a standard carbide blade in a circular saw or any grinder with a diamond blade. Round, curvy cuts can be made using any grinder with a diamond blade. Pre-sloped, ready to tile shower bases may be used in lieu of an ANSI Z124.1.2 plastic shower receptor or any liner based shower base installation.

See Figure 1 for typical installation of product within a fire-rated assembly.

When not provided with KurbX drain, drains must comply with ASME A112.18.2/CSA B125.2 as applicable.

Models:

The KurbX shower pans are pre-sloped, ready-to-tile floor units. Shower pans, curbs and membrane system assembly and components were proven to be waterproof when tested in accordance with IAPMO PS 106. Drains were found to be compliance with ASME A112.18.2/CSA B125.2

Shower system may include the following components: shower bases, curbs, waterproof membrane, sealing tape and drain.

Shower Pans

Model Number	Description
SB7248-CD	Structural Base 71" x 47 1/4" Center Drain
SB6060-CD	Structural Base 59" x 59" Center Drain
SB6048-CD	Structural Base 60" x 48" Center Drain
SB4848-CD	Structural Base 48" x 48" Center Drain
SB6036-CD	Structural Base 60" x 36" Center Drain
SB6036-OD-TR	Structural Base 60" x 36" Offset Drain for Tub Replacement

Shower Drain Waste Connectors

Model Number	Description
DWC825-ABS-2	Drain Waste Connector - ABS
DWC825-PVC-2	Drain Waste Connector - PVC

Drain Grate and Frame

Model Number	Description
GP-XXX-XX	2" Stainless Steel Drain in Various Grate Patterns and Finishes

XXX represents model number, XX represents finish

Waterproofing System

Model Number	Description
SeelIT	Waterproof Membrane
Sealing Tape	Polyester Non-Woven Tape and Corners

Foam Shower Curbs

Model Number	Description
KurbIT- 36	3' shower curb
KurbIT- 24	2' shower curb

Conditions of Listing:

1. Application is limited to use as shower sub-pans or lining.
2. The Shower Systems shall be installed in accordance with the manufacturer's published instructions and the applicable code(s).
3. Products recognized in this listing are manufactured under a quality control program with an annual surveillance inspection by ICC-ES.

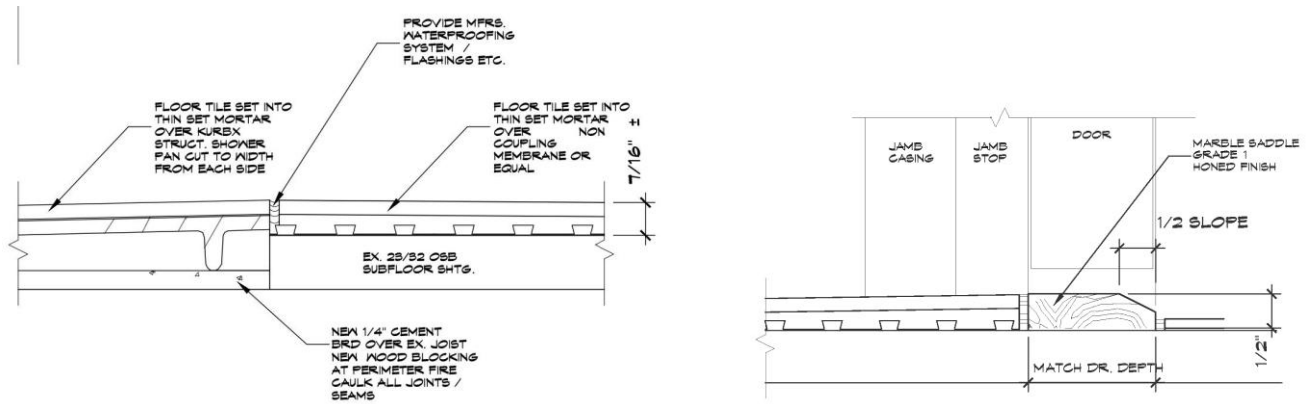

Figure 1: Typical Installation to Maintain Fire Rating of the Assembly