



ICC-ES Listing Report

Reissued May 2024

ESL-1336

This listing is subject to renewal May 2025.

CSI: DIVISION: 07 00 00—THERMAL AND MOISTURE PROTECTION
Section: 07 42 00—Wall Panels

Product Certification System:

The ICC-ES product-certification system includes evaluating reports of tests of standard manufactured product, prepared by accredited testing laboratories and provided by the listee, to verify compliance with applicable codes and standards. The system also involves factory inspections, and assessment and surveillance of the listee's quality system.

Product: NEXITE WALL PANEL ASSEMBLIES

Listee: NEXII BUILDING SOLUTIONS

Evaluation: Nexite wall panel assemblies are prefabricated panels, as described in the Assemblies section, and have been evaluated based on tested non-load bearing wall assemblies to the following standard:

- CAN/ULC-S101-14, Standard Method of Fire Endurance Tests of Building Construction and Materials, ULC Standards.

Assemblies:

Assembly A: 8-inch-thick (203 mm) Nexii Wall Panel Assembly 45 minutes fire-resistance rating for Nonbearing Wall Assembly with Interior Face Exposed (See Figure 1).

- **Exterior Face:** Exterior face of wall panel assembly must have a thickness of 0.75-inch (19 mm) Nexiite ST with fiberglass mesh cementitious coating.
- **Expanded Polystyrene Foam Core:** EPS foam plastic core of wall panel assembly has a thickness of 6.5 inches (165 mm) and complies with CAN/ULC S701, Type 2.
- **Interior Face:** Interior face of wall panel assembly must have a thickness of 0.75-inch (19 mm) Nexiite FS with fiberglass mesh cementitious coating.
- **Wall Panel Assembly Perimeter:** The perimeter of the wall panel assembly is composed of the Nexiite FS structural core frame. The top and bottom of the wall panel comes with steel tube having the following dimensions; 4-inch-by-4-inch-by-0.19-inch-thick (102 by 102 by 4.8 mm). All thread steel bars extend from the bottom of the steel tube to the top steel tube along the sides with 2-inch-by-2-inch-by-10 gage (51 by 51 by 3.4 mm) thick steel welded wire mesh. The panels must be connected together using 3-inch-by-3-inch-0.25-inch thick (76 by 76 by 6.4 mm) steel angle bolted to top and bottom steel tube.
- **Wall Panel Assembly Vertical Joint:** The vertical joint of the wall panel assembly is 0.5-inch (12.7 mm) wide. The joint must be packed with 4 pcf (64 kg/m³) Thermafiber Safing mineral wool insulation to a depth of 6 inches (152 mm). Recessed 0.5-inch (12.7 mm) from the interior face and 1.5 inches (38 mm) from the exterior face. A 0.5-inch-thick (12.7 mm) bead of Tremco Dymonic 100 Polyurethane sealant must be placed in the void on the interior surface and within the void on the exterior surface 1 inch (25.4 mm) below the surface. A foam backer rod must be placed on the exterior joint in front of the 0.5-inch (12.7 mm) bead of Tremco sealant to create a 0.5-inch (12.7 mm) recess from the exterior surface. The recessed void on the exterior surface must be filled with a 0.5-inch-thick (12.7 mm) bead of Tremco Spectrum 2 Silicone Structural Glazing Sealant.

Assembly B: 8-inch-thick (203 mm) Nexii Wall Panel Assembly 60 minutes fire-resistance rating for Nonbearing Wall Assembly with Interior Face Exposed (See Figure 1).

- **Exterior Face:** Exterior face of wall panel assembly must have a thickness of 1-inch (25.4 mm) Nexiite ST with fiberglass mesh cementitious coating.
- **Expanded Polystyrene Foam Core:** EPS foam plastic core of wall panel assembly has a thickness of 6 inches (152 mm) and complies with CAN/ULC S701, Type 2.
- **Interior Face:** Interior face of wall panel assembly must have a thickness of 1-inch (25.4 mm) Nexiite FS with fiberglass mesh cementitious coating.
- **Wall Panel Assembly Perimeter:** The perimeter of the wall panel assembly is composed of the Nexiite FS structural core frame. The top and bottom of the wall panel comes with steel tube having the following dimensions; 4-inch-by-4-inch-by-0.19-inch-thick (102 by 102 by 4.8 mm). All thread steel bars extend from the bottom of the steel tube to the top steel tube along the sides with 2-inch-by-2-inch-by-10 gage (51 by 51 by 3.4 mm) thick steel welded wire mesh. The panels must be connected together using 3-inch-by-3-inch-0.25-inch thick (76 by 76 by 6.4 mm) steel angle bolted to top and bottom steel tube.
- **Wall Panel Assembly Vertical Joint:** The vertical joint of the wall panel assembly is 0.5-inch (12.7 mm) wide. The joint must be packed with 4 pcf (64 kg/m³) Thermafiber Safing mineral wool insulation to a depth of 6 inches (152 mm). Recessed 0.5-inch (12.7 mm) from the interior face and 1.5 inches (38 mm) from the exterior face. A 0.5-inch-thick (12.7 mm) bead of Tremco Dymonic 100 Polyurethane sealant must be placed in the void on the interior surface and within the void on the exterior surface 1 inch (25.4 mm) below the surface. A foam backer rod must be placed on the exterior joint in front of the 0.5-inch (12.7 mm) bead of Tremco sealant to create a 0.5-inch (12.7 mm) recess from the exterior surface. The recessed void on the exterior surface must be filled with a 0.5-inch-thick (12.7 mm) bead of Tremco Spectrum 2 Silicone Structural Glazing Sealant.

Assembly C: 8-inch-thick (203 mm) Nexii Wall Panel Assembly 120 minutes fire-resistance rating for Nonbearing Wall Assembly with Interior Face Exposed (See Figure 1).

- **Exterior Face:** Exterior face of wall panel assembly must have a thickness of 1.5 inches (38 mm) Nexiite ST with fiberglass mesh cementitious coating.
- **Expanded Polystyrene Foam Core:** EPS foam plastic core of wall panel assembly has a thickness of 5 inches (127 mm) and complies with CAN/ULC S701, Type 2.
- **Interior Face:** Interior face of wall panel assembly must have a thickness of 1.5 inches (38 mm) Nexiite FS with fiberglass mesh cementitious coating.
- **Wall Panel Assembly Perimeter:** The perimeter of the wall panel assembly is composed of the Nexiite FS structural core frame. The top and bottom of the wall panel comes with steel tube having the following dimensions; 4-inch-by-4-inch-by-0.19-inch-thick (102 by 102 by 4.8 mm). All thread steel bars extend from the bottom of the steel tube to the top steel tube along the sides with 2-inch-by-2-inch-by-10 gage (51 by 51 by 3.4 mm) thick steel welded wire mesh. The panels must be connected together using 3-inch-by-3-inch-0.25-inch thick (76 by 76 by 6.4 mm) steel angle bolted to top and bottom steel tube.
- **Wall Panel Assembly Vertical Joint:** The vertical joint of the wall panel assembly is 0.5-inch (12.7 mm) wide. The joint must be packed with 4 pcf (64 kg/m³) Thermafiber Safing mineral wool insulation to a depth of 6 inches (152 mm). Recessed 0.5-inch (12.7 mm) from the interior face and 1.5 inches (38 mm) from the exterior face. A 0.5-inch-thick (12.7 mm) bead of Tremco Dymonic 100 Polyurethane sealant must be placed in the void on the interior surface and within the void on the exterior surface 1 inch (25.4 mm) below the surface. A foam backer rod must be placed on the exterior joint in front of the 0.5-inch (12.7 mm) bead of Tremco sealant to create a 0.5-inch (12.7 mm) recess from the exterior surface. The recessed void on the exterior surface must be filled with a 0.5-inch-thick (12.7 mm) bead of Tremco Spectrum 2 Silicone Structural Glazing Sealant.

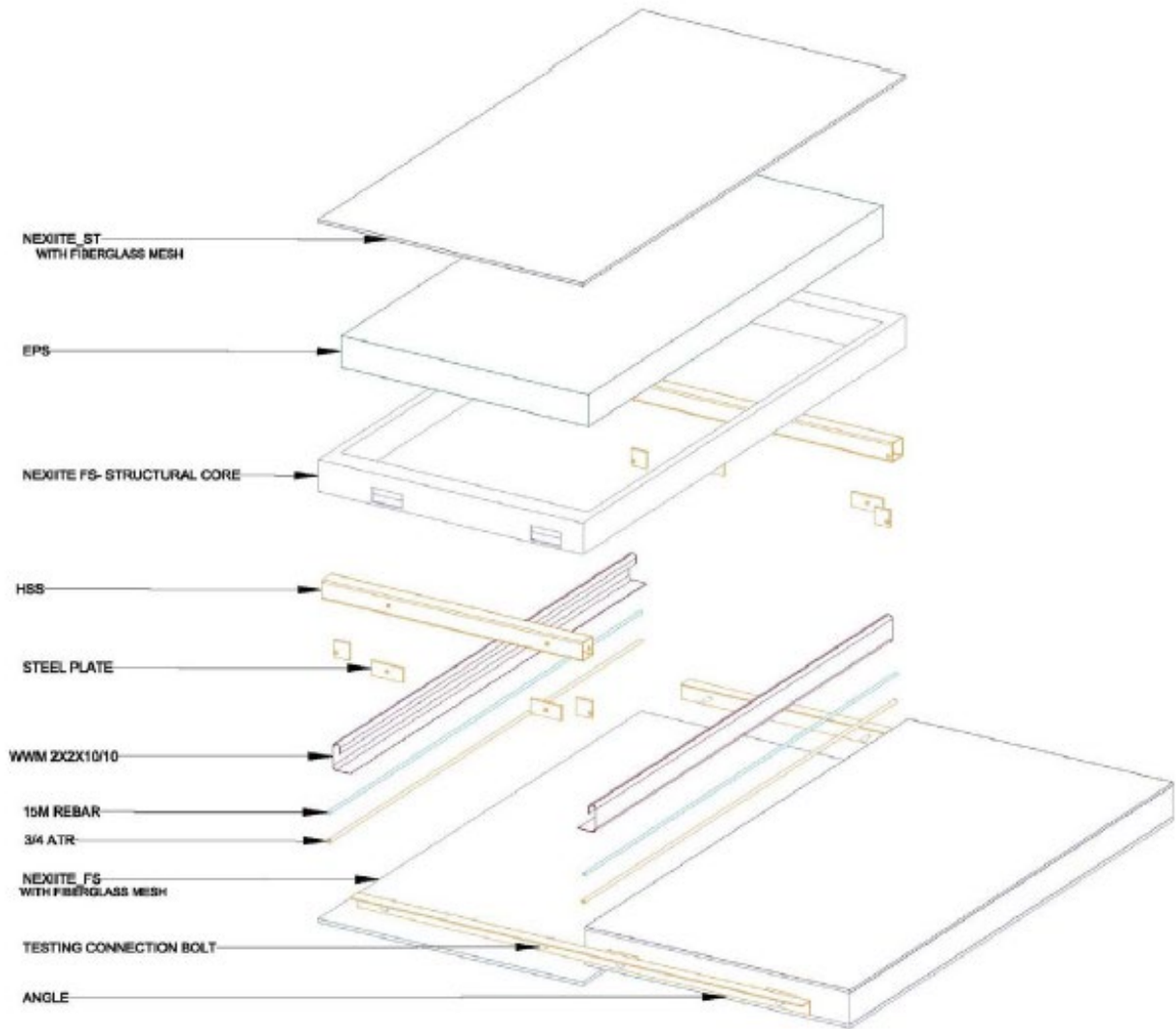

Figure 1- Fire-resistance-rated Assemblies A, B and C

Findings: The Nexite wall panel assemblies, described in the Assemblies section of this report, have met the conditions of acceptance as outlined in CAN/ULC-S101 for the fire-resistance ratings noted in each assembly, as referenced in the applicable sections of the following code editions.

- *National Building Code of Canada*® 2020 and 2015
Applicable Section: Volume 1, Division B, Section 3.1.7.

Identification:

1. The Nexite Wall Panel Assemblies carry a label indicating the manufacturer's name, the product name, the ICC-ES listing number (ESL-1336) and the ICC-ES Listing Mark, as applicable.
2. The report holder's contact information is the following:

NEXII BUILDING SOLUTIONS
1455 W GEORGIA ST
VANCOUVER, BRITISH COLUMBIA
V6G 2T3
CANADA
(778) 926-3944

Installation: The product must be installed in accordance with the Nexii Building Solutions published installation instructions and applicable codes.

Conditions of listing:

1. The listing report addresses only conformance with the standards and code sections noted above.
2. Approval of the product's use is the sole responsibility of the local code official.
3. The listing report applies only to the materials tested and as submitted for review by ICC-ES.
4. The Nexite Wall Panel Assemblies are manufactured under a quality control program with inspections by ICC-ES.